

Linear Engine

AUTOMATIC DOOR DRIVE UNIT

MM30 MM50 MM100

Distributed by:



Head office .Japan
12th Floor I Tower West I Umeda Skybuilding 1-30
Oyodonaka 1-chome I kita-ku osaka 531-0076
Japan
Tel: (0081) 6 6 4549721
Fax:(0081) 6 6 454 9726
Email:info@kenwa.co.jp

AUG. 2010



Versatile application.
Linear engine could be widely spread.

For example, it demonstrates its quiet and safe feature when it's used for residence, offices and hospitals, while it demonstrates its no-dust feature when it's used for factory clean rooms. With comprehensive advantages, linear engine automatic doors have been installed in many places and will extend its application to an even bigger market.



* Please contact us for any special requirements.

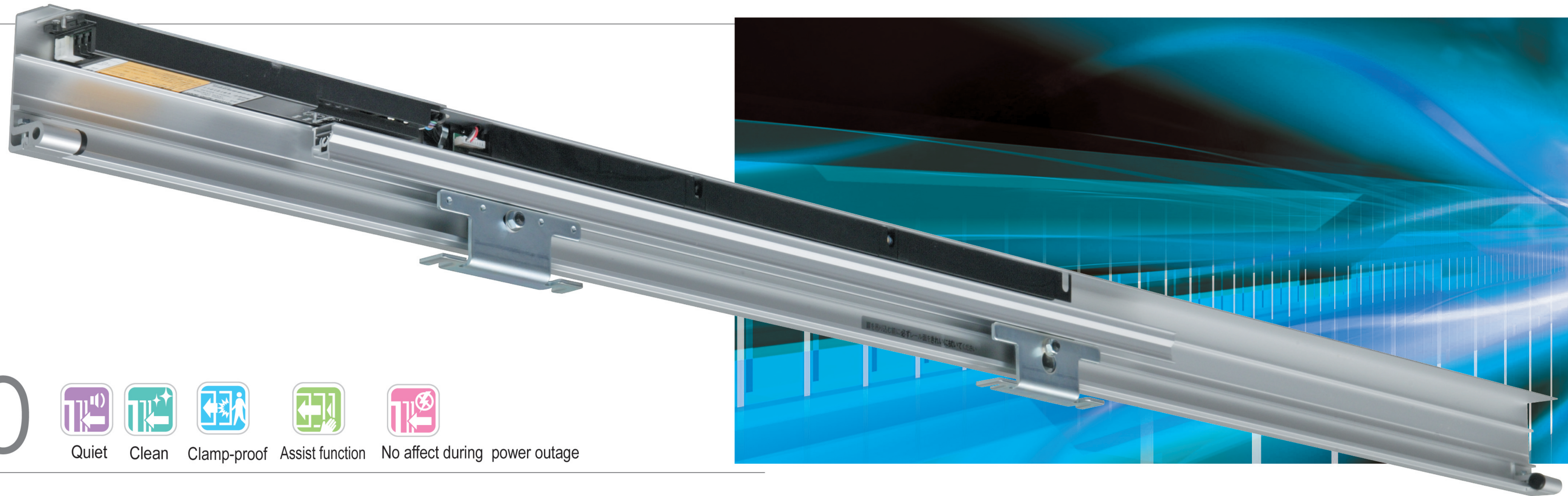

LINEAR ENGINE

MM50

- Quiet
- Clean
- Clamp-proof
- Assist function
- No affect during power outage

Recommended installation areas

- Office building
 - Meeting room
 - Smoking room
 - Office entrance
- Hospital & Welfare facilities
 - Living room
 - Clinic
 - Multifunctional toilets
- Factory
 - Clean room
 - Meeting room
- Public facilities
 - Multifunctional toilets
 - Child room



Assist function

After moving the door to direction of opening about 2cm, the door will open automatically, and after a certain time, the door will close automatically.

Highly safe return function

It can return the door immediately to a reverse direction when the door hits the body or obstacles during its opening.

Electronic locks compatible

If you use specialized electronic lock (referring to page 10) and combined with the card reader, you can create an enter management system.

Automatic type and assist type

This model includes 2 types: Automatic type and assist type. You can choose for your purpose.

Function	Automatic type	Assist type	Description
Assist function	Standard	Standard	Manually move the door by 2cm, the door will automatically open.
Hold full open	No	Standard	Withstand the door fully open for more than 3 seconds, the door will keep at the opening status.
Free stop	No	Standard	When the door is pushed back manually by 80mm during its opening, the door will stop at any position.
Half open	No	Standard	Adjust the opening scope by adjusting the knob between half-opening and full-opening.
Safety Stop	Standard	Standard	When the door detects the obstacle continuously by 2 times at the same position, the door would automatically stop for safety.
Equipped with electronic locks	Option	No	Choose to install electronic locks.
Synchronized opening	Standard	No	Use two engines to form the Bi-parting door.

Specifications

Model	MM 50		
Required power capacity	AC100V 10% 50/60Hz MAX: 4A		
Operating temperature	-10 ~ 40 °C		
Power consumption	Average when operating 0.2Wh/Once (Door Weight: 50kg/door)		
	Standby	No pushing force	2.8W (Starting sensors and auxiliary sensors are not included)
		Under pushing force	5.8W (Starting sensors and auxiliary sensors are not included)
Motor type	Magnet brushless DC linear motor movable type		
Thrust generation	When three stators are all fully lapped: 40N		
Door weight	20 ~ 50kg / Door		
Door width	>700mm (If the electric lock equipped : >800mm)		
* Self Weight	About 7kg		
Opening speed	0.2~0.5 m/sec (set default: 0.4 m/sec)		
Closing speed	Automatic type	0.2~0.5 m/sec (set default: 0.3 m/sec)	
	Assist type	0.2 m/sec (fixed)	
Hold open time	1 ~ 10 seconds .When it's set at maximum, it enters into ratchet action status (Set default: 3sec)		

* Weight may vary depending on rail length.

Section

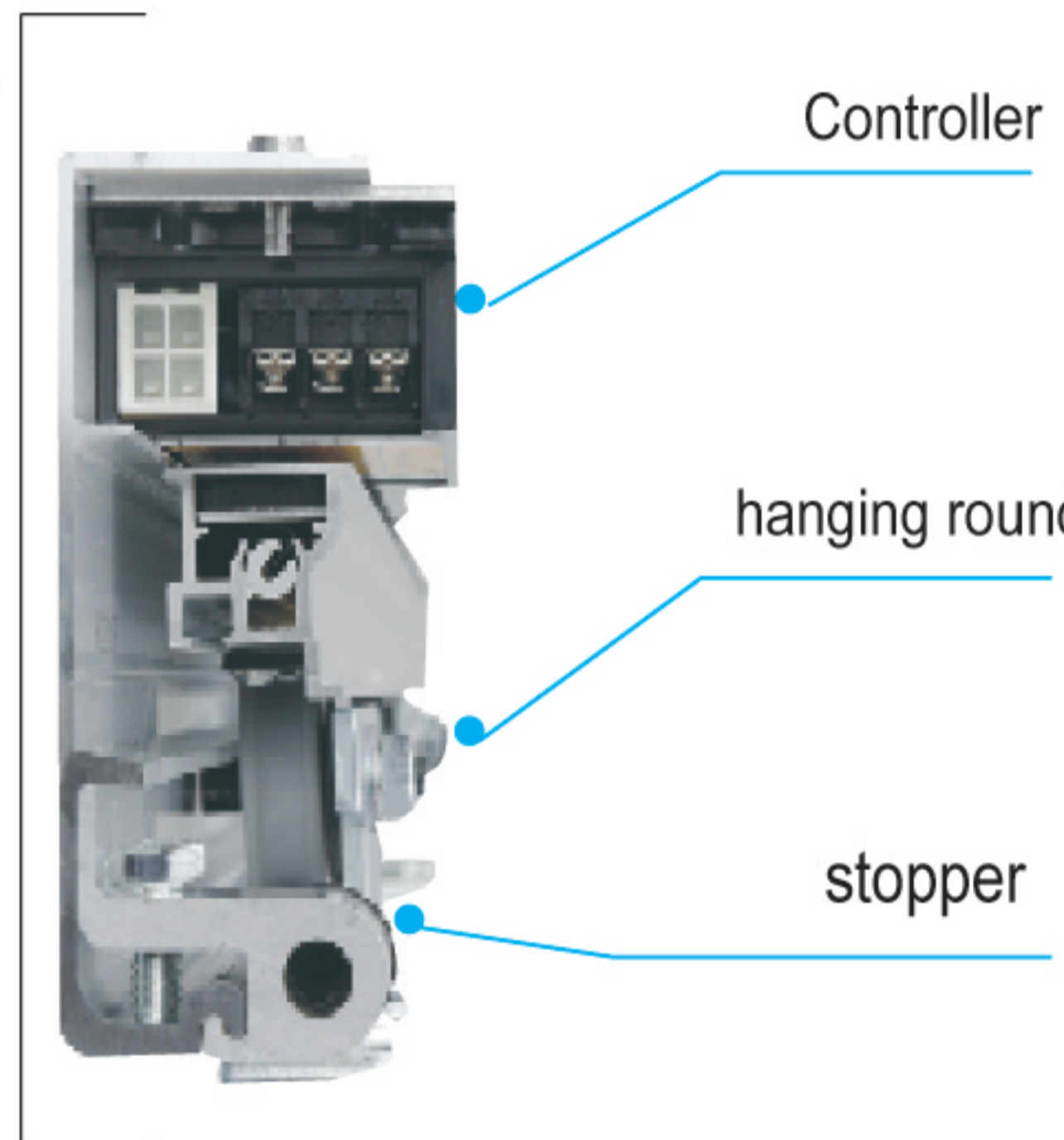

Section

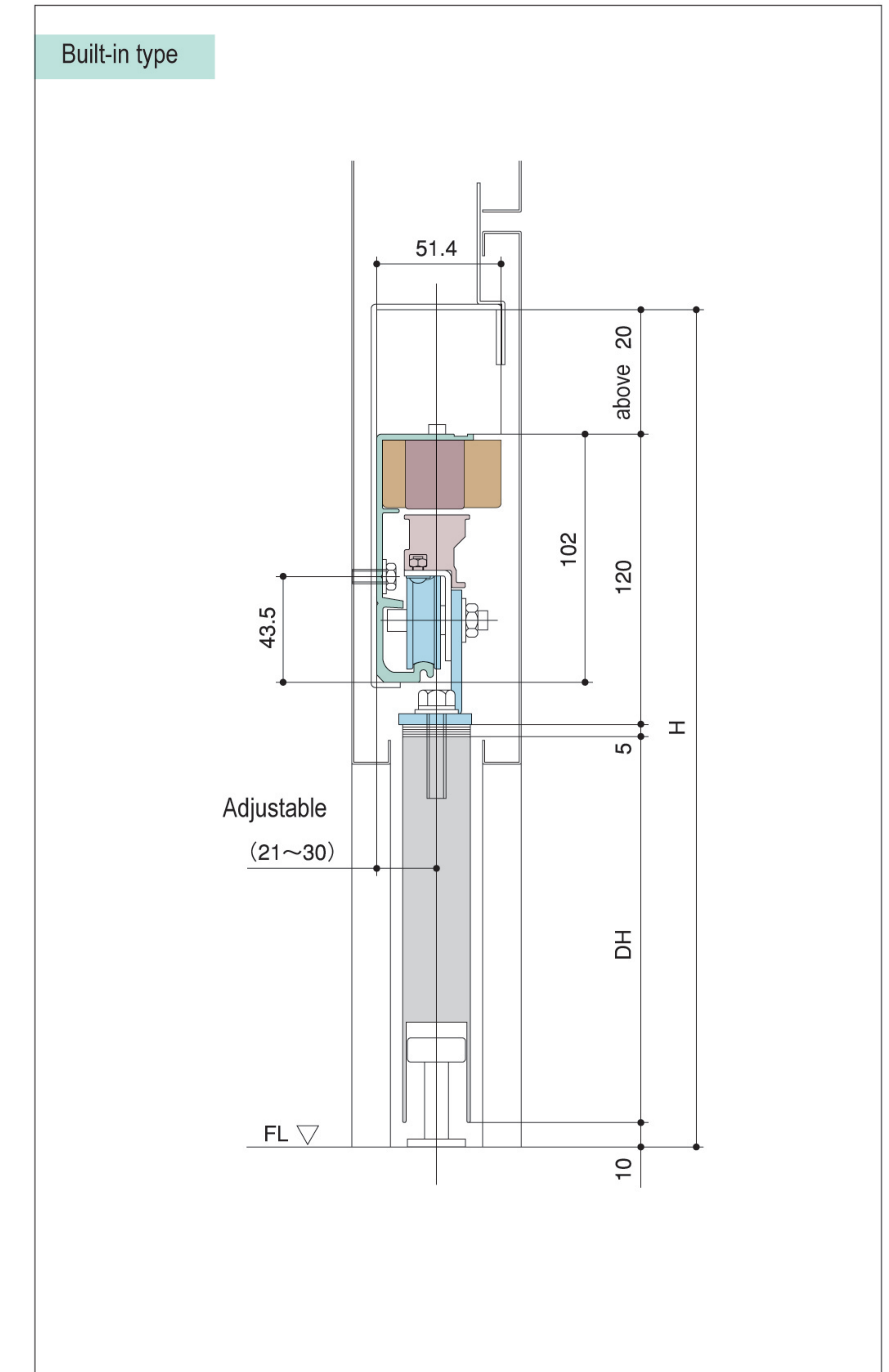
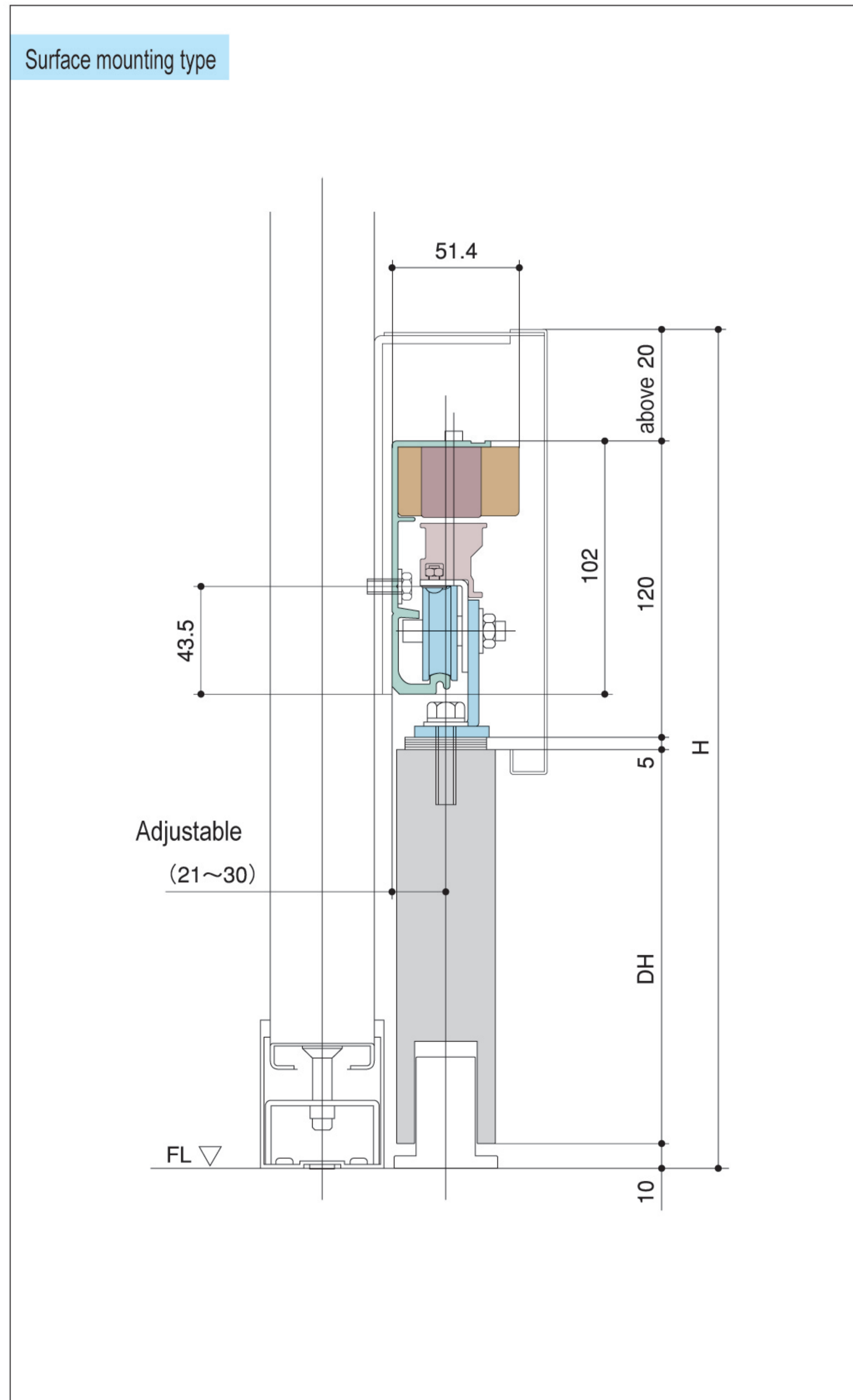



LINEAR ENGINE

MM100



Quiet



Clean



clamp-proof



No affect during power outage

Recommended place for installation



- Apartment building
 - Store
 - Office
 - Factory
- Entrance**

Office entrance



Shopping Entrance



Applicable the heavy door

It can open a single door of 30-90Kg or a Bi-parting door of 25-75Kg. It is extremely ideal for exterior doors

Quiet and smooth

Since the door is driven by a linear motor, it can be opened or closed in extremely quiet and smooth way.

Electronic locks compatible

If you use specialized electronic lock (referring to page 10) and combined with the card reader, you can create an enter management system.

Specifications

Model	MM100		
Required power capacity	AC100V 10% 50/60Hz MAX: 7A		
Operating temperature	-10 ~ 40 °C		
Power consumption	Average when operating	0.41Wh /Once (Bi-parting, Door weight: 75kg / Door)	
	Standby	2.1W (Starting sensors and auxiliary sensors are not included)	
Motor type	No pushing force	7.6W (Starting sensors and auxiliary sensors are not included)	
	Under pushing force	Magnet brushless DC linear motor movable type	
Thrust generation	When three stators are all fully lapped: 136N		
Door weight	Single	30 ~ 90kg / Door	
	Bi-parting	25 ~ 75kg / Door	
Door width	Single	>700mm (If the electric lock equipped : >830mm)	
	Bi-parting	>650mm	
※ Self Weight	Built-in type	Single	About 12kg
		Bi-parting	About 18kg
	Surface mounting type	Single	About 12kg
		Bi-parting	About 19kg
Opening speed	0.2 ~ 0.5m/sec (set default : 0.4m/sec)		
Closing speed	0.2 ~ 0.5m/sec (set default : 0.3m/sec)		
Hold open time	1 ~ 11 seconds (set default : 3sec)		

※ Weight may vary depending on rail length.

Section

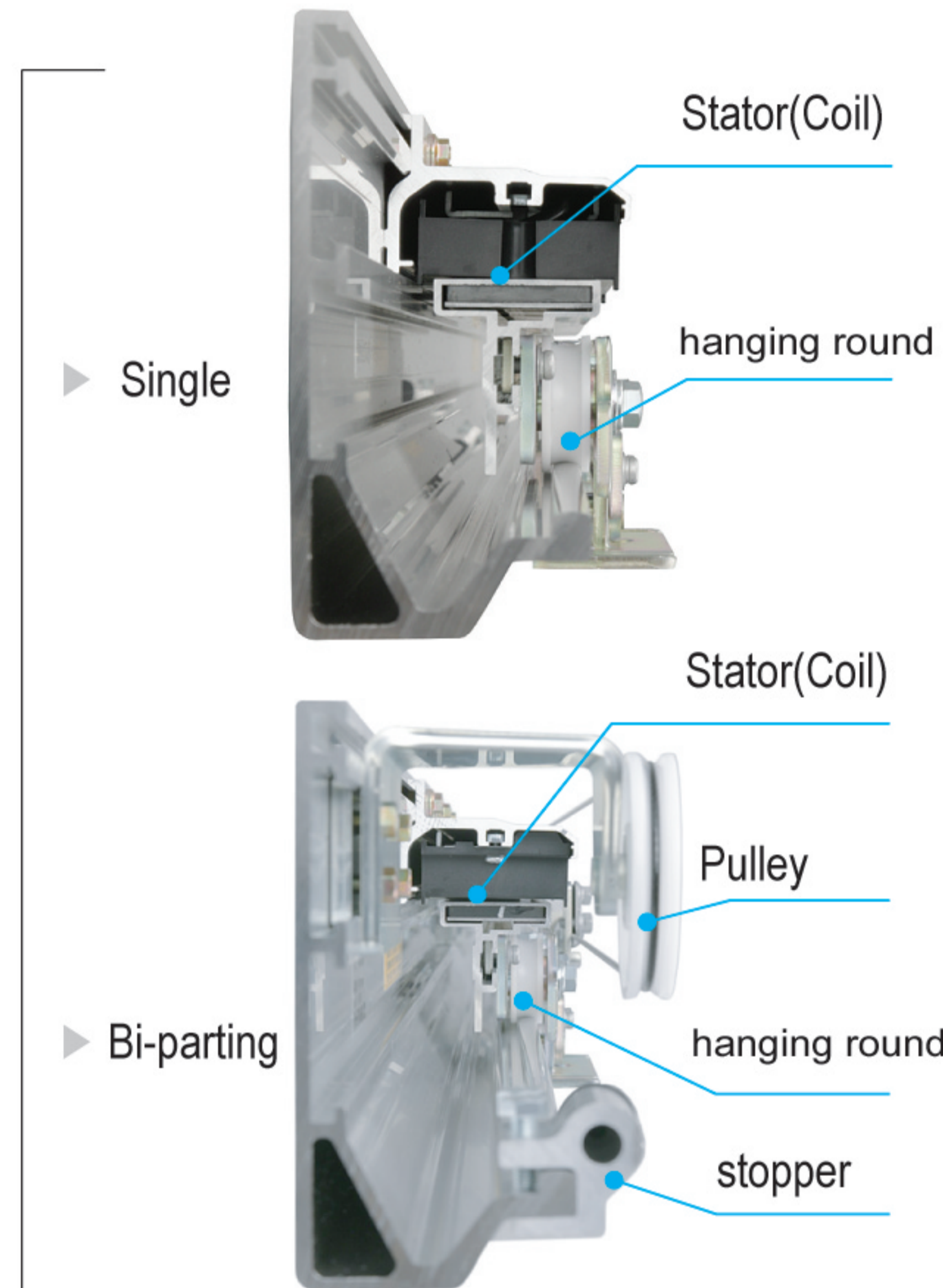

Section

